

CORONET

■入力軸回転速度 3000rpm

松下

ERK形 (ベース付横形)

M~C 枠



図-1

D 枠

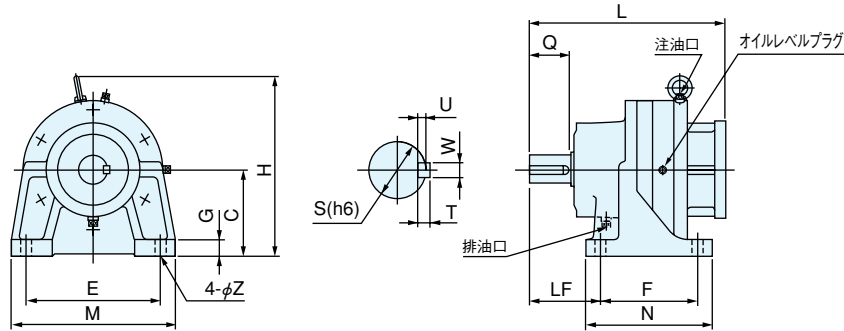
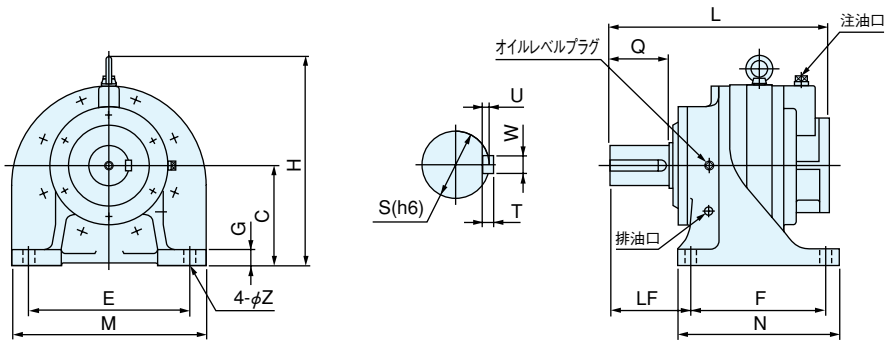

| 適用サーボ モータ形式 | モータ容量 (kW) | 減速機 機種 | 減速機枠番 | | 長さ L | 出力軸端 | | | | | | 高さ | | 横形ベース部 図-1 ベース | | | | | | |
|----------------|---------------|-----------|-------|----|---------|------|----|-----|------|----|----|-----|-----|-------------------|-----|-----|-----|-----|----|----|
| | | | NB | 標準 | | Q | S | WXU | T | TA | H | C | N | F | LF | M | E | G | Z | |
| | | | ○ | ○ | | mm | mm | mm | mm | mm | mm | mm | mm | mm | mm | mm | mm | mm | mm | |
| MSM012 | 0.1 | ERK- | M | ○ | ○ | 159 | 25 | 14 | 5×3 | 5 | — | 110 | 60 | 75 | 55 | 45 | 110 | 90 | 9 | 9 |
| MSM022 | 0.2 | ERK- | M | ○ | ○ | 149 | 25 | 14 | 5×3 | 5 | — | 110 | 60 | 75 | 55 | 45 | 110 | 90 | 9 | 9 |
| MSM042 | 0.4 | ERK- | B | ○ | ○ | 213 | 40 | 28 | 8×4 | 7 | — | 196 | 90 | 135 | 105 | 75 | 175 | 145 | 16 | 12 |
| MSM082 | 0.75 | ERK- | B | ○ | ○ | 223 | 40 | 28 | 8×4 | 7 | — | 196 | 90 | 135 | 105 | 75 | 175 | 145 | 16 | 12 |
| | | | C | ○ | ○ | 264 | 55 | 38 | 10×5 | 8 | — | 241 | 115 | 170 | 130 | 95 | 220 | 180 | 22 | 15 |
| MSM102 | 1.0 | ERK- | B | ○ | ○ | 225 | 40 | 28 | 8×4 | 7 | — | 196 | 90 | 135 | 105 | 75 | 175 | 145 | 16 | 12 |
| | | | C | ○ | ○ | 271 | 55 | 38 | 10×5 | 8 | — | 241 | 115 | 170 | 130 | 95 | 220 | 180 | 22 | 15 |
| MSM152 | 1.5 | ERK- | B | — | ○ | 223 | 40 | 28 | 8×4 | 7 | — | 221 | 115 | 135 | 105 | 75 | 175 | 145 | 16 | 12 |
| | | | C | ○ | ○ | 264 | 55 | 38 | 10×5 | 8 | — | 241 | 115 | 170 | 130 | 95 | 220 | 180 | 22 | 15 |
| | | | D | ○ | ○ | 339 | 80 | 55 | 16×6 | 10 | — | 299 | 140 | 200 | 150 | 120 | 275 | 225 | 26 | 19 |
| MSM202 | 2.0 | ERK- | B | — | ○ | 223 | 40 | 28 | 8×4 | 7 | — | 221 | 115 | 135 | 105 | 75 | 175 | 145 | 16 | 12 |
| | | | C | ○ | ○ | 264 | 55 | 38 | 10×5 | 8 | — | 241 | 115 | 170 | 130 | 95 | 220 | 180 | 22 | 15 |
| | | | D | ○ | ○ | 339 | 80 | 55 | 16×6 | 10 | — | 299 | 140 | 200 | 150 | 120 | 275 | 225 | 26 | 19 |
| MSM252 | 2.5 | ERK- | C | ○ | ○ | 264 | 55 | 38 | 10×5 | 8 | — | 241 | 115 | 170 | 130 | 95 | 220 | 180 | 22 | 15 |
| | | | D | ○ | ○ | 339 | 80 | 55 | 16×6 | 10 | — | 299 | 140 | 200 | 150 | 120 | 275 | 225 | 26 | 19 |
| MSM302 | 3.0 | ERK- | C | ○ | ○ | 264 | 55 | 38 | 10×5 | 8 | — | 241 | 115 | 170 | 130 | 95 | 220 | 180 | 22 | 15 |
| | | | D | ○ | ○ | 334 | 80 | 55 | 16×6 | 10 | — | 299 | 140 | 200 | 150 | 120 | 275 | 225 | 26 | 19 |
| MSM352 | 3.5 | ERK- | C | — | ○ | 264 | 55 | 38 | 10×5 | 8 | — | 241 | 115 | 170 | 130 | 95 | 220 | 180 | 22 | 15 |
| | | | D | ○ | ○ | 334 | 80 | 55 | 16×6 | 10 | — | 299 | 140 | 200 | 150 | 120 | 275 | 225 | 26 | 19 |
| MSM402 | 4.0 | ERK- | C | — | ○ | 279 | 55 | 38 | 10×5 | 8 | — | 266 | 140 | 170 | 130 | 95 | 220 | 180 | 22 | 15 |
| | | | D | ○ | ○ | 339 | 80 | 55 | 16×6 | 10 | — | 299 | 140 | 200 | 150 | 120 | 275 | 225 | 26 | 19 |
| MSM452 | 4.5 | ERK- | C | — | ○ | 279 | 55 | 38 | 10×5 | 8 | — | 266 | 140 | 170 | 130 | 95 | 220 | 180 | 22 | 15 |
| | | | D | ○ | ○ | 339 | 80 | 55 | 16×6 | 10 | — | 299 | 140 | 200 | 150 | 120 | 275 | 225 | 26 | 19 |
| MSM502 | 5.0 | ERK- | C | — | ○ | 279 | 55 | 38 | 10×5 | 8 | — | 266 | 140 | 170 | 130 | 95 | 220 | 180 | 22 | 15 |
| | | | D | ○ | ○ | 339 | 80 | 55 | 16×6 | 10 | — | 299 | 140 | 200 | 150 | 120 | 275 | 225 | 26 | 19 |

モータ取付フランジ部



図-3



図-4

ERK-V形(フランジ付たて形)

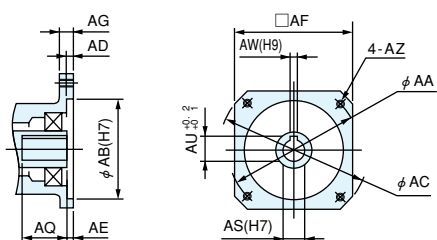
M~C 枠

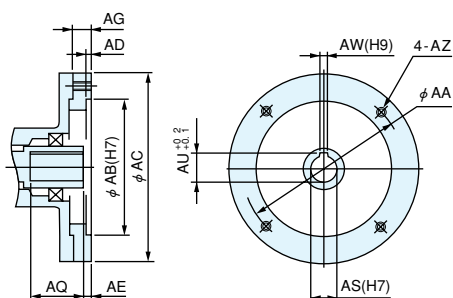
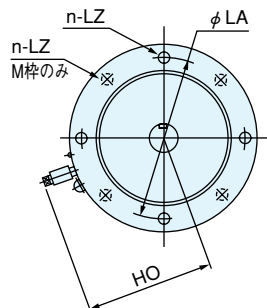
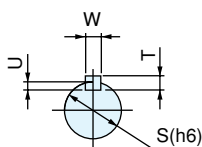
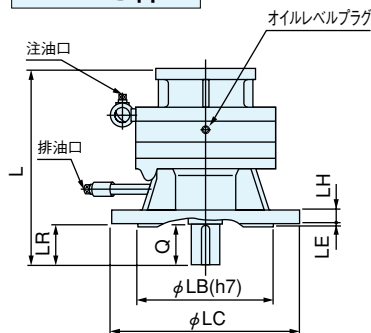

D 枠

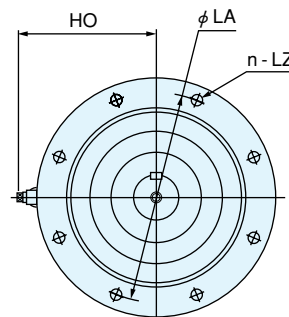
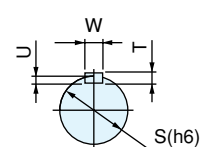
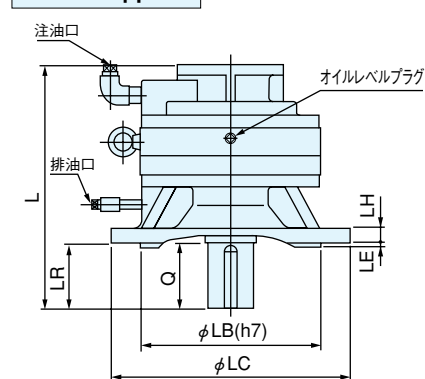

図-2

| たて形フランジ部 | | 図-2 | | | | | | | | | | | | | | | | 図示 | | 油量 (ℓ) | | 質量 (kg) | | | | | | |
|----------|-----|-----|----|----|------|----|-----|------------|-----|-----|----|----|-----|----|----|----|----|----|------|--------|------|---------|----|----|-----|-----|----|-----|
| フランジ | | | | | | | | モータ取付フランジ部 | | | | | | | | | | | | | | | | 番号 | 横形 | タテ形 | 横形 | タテ形 |
| LC | LB | LA | LE | LH | n-LZ | LR | HO | AA | AB | AC | AD | AE | AF | AG | AZ | AQ | AS | AW | AU | 番号 | 横形 | タテ形 | 横形 | | タテ形 | | | |
| 100 | 70 | 85 | 4 | 8 | 4-7 | 25 | — | 45 | 30 | 80 | 5 | 5 | 60 | 10 | M3 | 22 | 8 | 3 | 9.2 | 3 | グリース | グリース | 4 | 4 | | | | |
| 100 | 70 | 85 | 4 | 8 | 4-7 | 25 | — | 70 | 50 | 110 | 5 | 7 | 80 | 10 | M4 | 25 | 11 | 4 | 12.5 | 3 | グリース | グリース | 3 | 3 | | | | |
| 200 | 130 | 165 | 4 | 14 | 4-12 | 40 | 131 | 70 | 50 | 120 | 5 | 5 | — | 10 | M4 | 27 | 14 | 5 | 16 | 4 | 0.22 | 0.4 | 13 | 13 | | | | |
| 200 | 130 | 165 | 4 | 14 | 4-12 | 40 | 131 | 90 | 70 | 135 | 5 | 5 | 100 | 15 | M5 | 32 | 19 | 6 | 21.5 | 3 | 0.22 | 0.4 | 14 | 14 | | | | |
| 250 | 180 | 215 | 4 | 18 | 4-15 | 55 | 168 | 90 | 70 | 160 | 7 | 7 | — | 15 | M5 | 30 | 19 | 6 | 21.5 | 4 | 0.45 | 0.81 | 26 | 26 | | | | |
| 200 | 130 | 165 | 4 | 14 | 4-12 | 40 | 131 | 100 | 80 | 120 | 7 | 7 | — | 22 | M6 | 50 | 19 | 6 | 21.5 | 4 | 0.22 | 0.4 | 14 | 14 | | | | |
| 250 | 180 | 215 | 4 | 18 | 4-15 | 55 | 168 | 100 | 80 | 120 | 5 | 7 | — | 22 | M6 | 50 | 19 | 6 | 21.5 | 4 | 0.45 | 0.81 | 26 | 26 | | | | |
| 200 | 130 | 165 | 4 | 14 | 4-12 | 40 | 131 | 115 | 95 | 135 | 5 | 7 | 100 | 15 | M8 | 50 | 19 | 6 | 21.5 | 3 | 0.22 | 0.4 | 14 | 14 | | | | |
| 250 | 180 | 215 | 4 | 18 | 4-15 | 55 | 168 | 115 | 95 | 165 | 7 | 7 | 130 | 15 | M8 | 50 | 19 | 6 | 21.5 | 3 | 0.45 | 0.81 | 26 | 26 | | | | |
| 300 | 230 | 265 | 5 | 22 | 8-15 | 80 | 199 | 115 | 95 | 200 | 5 | 7 | — | 15 | M8 | 50 | 19 | 6 | 21.5 | 4 | 0.9 | 1.5 | 49 | 49 | | | | |
| 200 | 130 | 165 | 4 | 14 | 4-12 | 40 | 131 | 115 | 95 | 135 | 5 | 7 | 100 | 15 | M8 | 50 | 19 | 6 | 21.5 | 3 | 0.22 | 0.4 | 14 | 14 | | | | |
| 250 | 180 | 215 | 4 | 18 | 4-15 | 55 | 168 | 115 | 95 | 165 | 7 | 7 | 130 | 15 | M8 | 50 | 19 | 6 | 21.5 | 3 | 0.45 | 0.81 | 26 | 26 | | | | |
| 300 | 230 | 265 | 5 | 22 | 8-15 | 80 | 199 | 115 | 95 | 200 | 5 | 7 | — | 15 | M8 | 50 | 19 | 6 | 21.5 | 4 | 0.9 | 1.5 | 49 | 49 | | | | |
| 250 | 180 | 215 | 4 | 18 | 4-15 | 55 | 168 | 115 | 95 | 165 | 7 | 7 | 130 | 15 | M8 | 50 | 19 | 6 | 21.5 | 3 | 0.45 | 0.81 | 26 | 26 | | | | |
| 300 | 230 | 265 | 5 | 22 | 8-15 | 80 | 199 | 115 | 95 | 200 | 5 | 7 | — | 15 | M8 | 50 | 19 | 6 | 21.5 | 4 | 0.9 | 1.5 | 49 | 49 | | | | |
| 250 | 180 | 215 | 4 | 18 | 4-15 | 55 | 168 | 145 | 110 | 165 | 7 | 8 | 130 | 15 | M8 | 49 | 22 | 8 | 25 | 3 | 0.45 | 0.81 | 26 | 26 | | | | |
| 300 | 230 | 265 | 5 | 22 | 8-15 | 80 | 199 | 145 | 110 | 165 | 7 | 10 | 130 | 18 | M8 | 47 | 22 | 8 | 25 | 3 | 0.9 | 1.5 | 47 | 47 | | | | |
| 250 | 180 | 215 | 4 | 18 | 4-15 | 55 | 168 | 145 | 110 | 165 | 7 | 8 | 130 | 15 | M8 | 49 | 22 | 8 | 25 | 3 | 0.45 | 0.81 | 26 | 26 | | | | |
| 300 | 230 | 265 | 5 | 22 | 8-15 | 80 | 199 | 145 | 110 | 165 | 7 | 10 | 130 | 18 | M8 | 47 | 22 | 8 | 25 | 3 | 0.9 | 1.5 | 47 | 47 | | | | |
| 250 | 180 | 215 | 4 | 18 | 4-15 | 55 | 168 | 145 | 110 | 165 | 7 | 10 | — | 18 | M8 | 57 | 24 | 8 | 27 | 4 | 0.45 | 0.81 | 28 | 28 | | | | |
| 300 | 230 | 265 | 5 | 22 | 8-15 | 80 | 199 | 145 | 110 | 200 | 7 | 10 | — | 15 | M8 | 57 | 24 | 8 | 27 | 4 | 0.9 | 1.5 | 51 | 51 | | | | |
| 250 | 180 | 215 | 4 | 18 | 4-15 | 55 | 168 | 145 | 110 | 165 | 7 | 10 | — | 18 | M8 | 57 | 24 | 8 | 27 | 4 | 0.45 | 0.81 | 28 | 28 | | | | |
| 300 | 230 | 265 | 5 | 22 | 8-15 | 80 | 199 | 145 | 110 | 200 | 7 | 10 | — | 15 | M8 | 57 | 24 | 8 | 27 | 4 | 0.9 | 1.5 | 51 | 51 | | | | |
| 250 | 180 | 215 | 4 | 18 | 4-15 | 55 | 168 | 145 | 110 | 165 | 7 | 10 | — | 18 | M8 | 57 | 24 | 8 | 27 | 4 | 0.45 | 0.81 | 28 | 28 | | | | |
| 300 | 230 | 265 | 5 | 22 | 8-15 | 80 | 199 | 145 | 110 | 200 | 7 | 10 | — | 15 | M8 | 57 | 24 | 8 | 27 | 4 | 0.9 | 1.5 | 51 | 51 | | | | |